



As you receive this newsletter, Charles Street will be getting ready to re-open after the widening and resurfacing. The project went extremely well

and the cooperation and understanding of the neighbors have been exceptional. Curbs on Charles were finished the end of April and sidewalks early May. As Charles Street opens, Collett Street between High and North Streets will be closed. What was previously High Street between Collett and Charles becomes part of the Grand Boulevard Entrance for the Medical Center of the Future.

You might also notice the Medical Office Buildings (MOB) parking lots look much better. The parking lots had to be accessible even as waterlines, power and other infrastructure had to be constructed. Unfortunately it is not something that can be done all at once, so temporary surfacing had to be done several times.

The lots are once again complete with a permanent asphalt surface. A traffic signal will be activated at the entry to the MOB lots in July. This will greatly improve traffic flow and make entering and exiting considerably easier. A new Baxter Street access will make deliveries much easier and improve truck traffic around the medical center.

I continue to get comments and suggestions about the overall project as well as the Construction Newsletter which I appreciate.

Thank you all for your continued understanding and cooperation.

Ron Connovich
Director of Facilities
and Construction Services
rdconnovich@health-partners.org

CHARLES STREET TO OPEN



Charles Street after the final paving, before lanes were striped.

Charles Street officially opens June 1, 2005. Barring any weather setbacks it should be all but finished as you receive this newsletter. Widening Charles Street to three lanes was an essential part of building the Medical Center of the Future. It will eventually help create the new entrance, as well as ease north-south

traffic flow. As Charles Street opens, Collett Street between North and High Streets will permanently close.

The former High Street between Charles and Collett becomes the Grand Boulevard Entrance. It is two-way so employees will be able to enter Lot 18 from the Boulevard entrance. Visitors will be able to access Lot 1 from

Continued...



In the Spotlight

Brian Kecec, MEP (Mechanical, Electrical and Plumbing) Project Engineer is in his second year with McCarthy and working on his first health care project. His primary focus is the new Patient Tower and the temporary relocation of the dietary infrastructure. He previously worked on the Rensselaer Polytechnic Institute project in Troy, New York where he worked with Brian Baldwin, who is also on the Medical Center of the Future project.



A graduate of the University of Missouri -Rolla with a degree in Mechanical Engineering, Kecec attended college on a baseball scholarship... four years as a player (lead-off batter, short stop and second base) and the fifth year working with the team as an assistant coach.

According to Kecec, building around the existing facilities and services is one of the most interesting parts of the job. One of the most exciting is being part of something that will have such a major impact on the community.

"Knowing what you are doing will help the over-all community so much is exciting. Helping to build a facility like the Medical Center of the Future that will provide great health care and create more job opportunities for the community is very rewarding," he said.

In addition to keeping very busy on the job, Kecec also has other major plans. He will be getting married in October to his hometown sweetheart Amy Smith.

CHARLES STREET TO OPEN

(continued)

Market Street, Collett Street or the Grand Boulevard. Valet Parking remains unchanged at this time... accessible from Collett.

"I was very impressed with the cooperation of the people in the neighborhood along with St. Rita's medical center employees," said Todd Freed, McCarthy Project Director. "Certainly these neighbors were inconvenienced and had limited access to their drives for part of the time, but for the most part, they were very understanding and agreeable. The staff and patrons from the First Church of Christ, Scientist were also great during the construction of their relocated facility and the street work outside their front door. Everyone worked with us to make sure everything went as smoothly as possible. It was an exceptionally positive experience."

After the infrastructure and preliminary widening work was complete, Charles Street was graveled, compacted and fine graded. The final asphalt top coating was completed just as the weather was

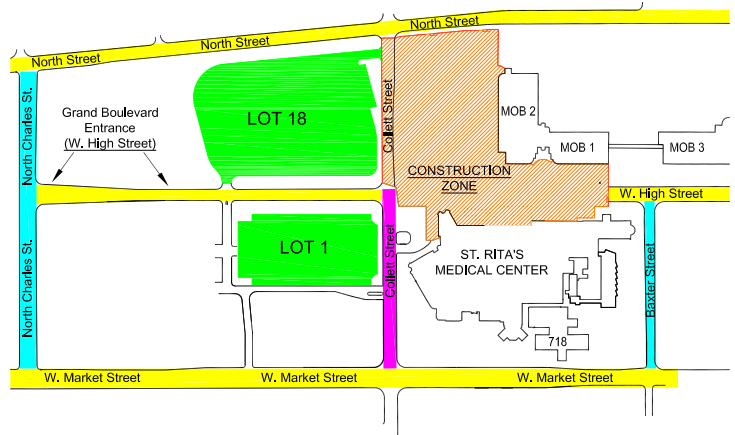

warm enough for asphalt application. Concrete curbs and sidewalks were installed and finished at the beginning of May. Landscaping south of High Street will be done in the fall after the completion of some new adjacent parking lot construction.

In July, new lights will be installed at the corner of Charles and North Streets, as well as Charles and Market Streets. (The light currently at Collett and North will eventually be removed.) A new light will also be installed at the entrance to the Medical Office Buildings parking lots, at the Baxter Street intersection and will be activated in July. The City has indicated that lights will be synchronized so traffic may proceed smoothly on North Street.



The new AEP substation was installed in May. The connections shown here are prior to the pad being poured. The substation will re-feed power to the entire campus including the new patient tower.



Bishop Leonard Blair, Diocese of Toledo made time to add his name to the "Signature Beam" during a recent visit St. Rita's Medical Center. With Bishop Blair are St. Rita's President and CEO, Jim Reber (center) and Mark Skaja, St. Rita's Vice President of Mission Services. The beam was in the main lobby so employees, visitors and patients could sign it. The open beam will be placed at the top of St. Rita's nine-story patient tower, part of the \$130 million Medical Center of the Future expansion.

MOB PARKING LOTS FINISH, FINISHED!

The Medical Office Buildings (MOB) parking lots are finished! The lots have been temporarily finished several times as infrastructure, power and water lines were added. Unfortunately most of the work could not be done at the same time. Those using the lots noticed a variety of barriers, trenches and re-direction of physician, staff and customer parking over several months.

The new curbs were all complete in April and the new entry constructed. A new stoplight at the Baxter Street intersection will be activated in July. This will make it much easier (and safer) to enter and exit the lots from North Street, which is the way all MOB traffic should access the lots.

The lots are now finished with the asphalt top coat complete. The "final" finish was a one day operation, done on a week-end to provide the least possible inconvenience to patients and physicians.

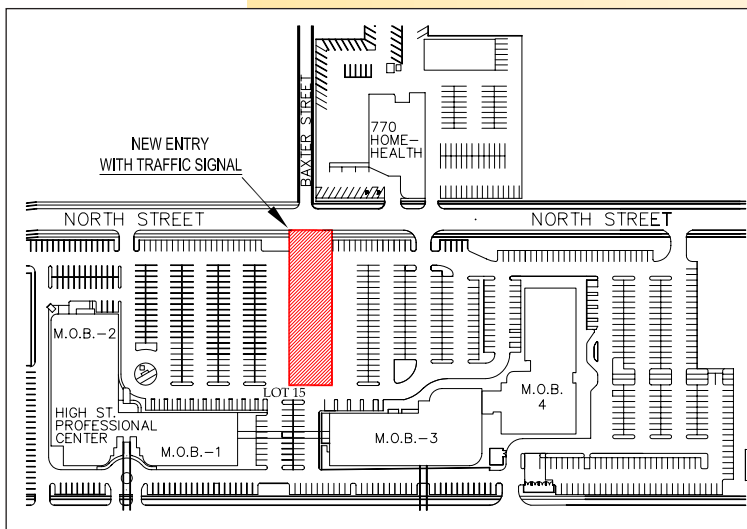

The lots have also been extended to Metcalf Street. Currently some of the expanded parking is being used by some of the 125+ outside construction workers currently working on site. That number will grow to more than 300 in June and will be at that number and higher for many months.

Project Schedule:

Mass Excavation	April 05 – May 05
Foundations	May 05 – Oct. 05
Structural Steel	Sept. 05 – Feb. 06
Building Enclosure	Feb. 06 - Oct. 06
Interior Fit-out	Feb. 06 - Dec. 07
Occupancy	December 2007

St. Rita's Construction
CORNER

Q&A

Question and Answer

Q: How are we doing with the project Budget?

A: The loading dock and infrastructure upgrade was estimated to cost about \$21M. It is now 100% contracted and is right on budget with an estimated completion date of mid July. We have also contracted almost \$17M of the new patient tower and are slightly under budget ... all thanks to McCarthy's excellent job at estimating the construction costs.

Q: Why is the hole for the new patient tower so big?

A: The hole is indeed much deeper and larger than the actual patient tower. Foundations and walls need to be poured, waterproofed, drain-tile installed and then back-filled. Slightly less than half a million cubic feet of dirt is being removed and stored off site. Some of the dirt will be returning to our campus as back-fill for the patient tower. That's about 1,800 truck-loads or more than 1/3 of all the dirt being hauled away! The remaining dirt was hauled to the Lima City Schools demolition backfill and land development east of Wal-Mart on Harding Highway.

To view or print copies of St. Rita's Construction Corner visit our website at www.stritas.org

If you would like to receive *St. Rita's Construction Corner* on a regular basis, please drop us a message with your name and address and you will be added to the mailing list:

St. Rita's Medical Center
Attention: Public Relations
730 W. Market Street
Lima, OH 45801

Or drop us an e-mail with your name and address to: tlprofit@health-partners.org



730 West Market Street
Lima, Ohio 45801-4667
www.stritas.org

Address Service Requested

Did You Know?

The elevator in the new loading dock will be the largest elevator on our campus. It will be 8 feet wide and 15 feet deep and able to carry 10,000 lbs! This new elevator by Kone will be large enough to carry a full size car — if we could figure out how to actually get the car in the building.



St. Rita's Construction
CORNER